

MS27595 Solid PTFE Backups - Inch

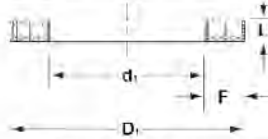

ALTERNATIVE SEALS:
8-, 18-, 51-, MS28774, MS28782, MS28783



These solid PTFE backup rings are machined from virgin PTFE to military drawings and are popular in commercial applications requiring low friction, fluid compatibility or high temperature. The solid design is easier to install in larger bore sizes as there are no ends to catch. These parts do not meet Mil-Spec testing requirements. Prices can be quoted for military applications requiring additional testing and certification.

EXAMPLE: MS27595-352

Prefix	AS568 DASH #
MS27595 -	352

Part No.
MS27595-004
MS27595-005
MS27595-006
MS27595-007
MS27595-008
MS27595-009
MS27595-010
MS27595-011
MS27595-012
MS27595-013
MS27595-014
MS27595-015
MS27595-016
MS27595-017
MS27595-018
MS27595-019
MS27595-020
MS27595-021
MS27595-022
MS27595-023
MS27595-024
MS27595-025
MS27595-026
MS27595-027
MS27595-028
MS27595-029
MS27595-032
MS27595-035
MS27595-036
MS27595-038
MS27595-040
MS27595-041
MS27595-044
MS27595-049
MS27595-106
MS27595-108
MS27595-109
MS27595-110
MS27595-111
MS27595-112
MS27595-113
MS27595-114
MS27595-115
MS27595-116
MS27595-117
MS27595-118
MS27595-119
MS27595-120
MS27595-121
MS27595-122

Part No.
MS27595-123
MS27595-124
MS27595-125
MS27595-126
MS27595-127
MS27595-128
MS27595-129
MS27595-130
MS27595-131
MS27595-132
MS27595-133
MS27595-134
MS27595-135
MS27595-136
MS27595-137
MS27595-138
MS27595-139
MS27595-140
MS27595-141
MS27595-142
MS27595-143
MS27595-144
MS27595-145
MS27595-146
MS27595-147
MS27595-148
MS27595-149
MS27595-150
MS27595-151
MS27595-152
MS27595-154
MS27595-156
MS27595-157
MS27595-158
MS27595-166
MS27595-210
MS27595-211
MS27595-212
MS27595-213
MS27595-214
MS27595-215
MS27595-216
MS27595-217
MS27595-218
MS27595-219
MS27595-220
MS27595-221
MS27595-222
MS27595-223
MS27595-224

Part No.
MS27595-225
MS27595-226
MS27595-227
MS27595-228
MS27595-229
MS27595-230
MS27595-231
MS27595-232
MS27595-233
MS27595-234
MS27595-235
MS27595-236
MS27595-237
MS27595-238
MS27595-239
MS27595-240
MS27595-241
MS27595-242
MS27595-243
MS27595-244
MS27595-245
MS27595-246
MS27595-247
MS27595-248
MS27595-249
MS27595-250
MS27595-251
MS27595-252
MS27595-253
MS27595-254
MS27595-255
MS27595-256
MS27595-257
MS27595-258
MS27595-259
MS27595-260
MS27595-261
MS27595-262
MS27595-263
MS27595-264
MS27595-265
MS27595-266
MS27595-267
MS27595-268
MS27595-269
MS27595-270

Part No.
MS27595-272
MS27595-273
MS27595-277
MS27595-278
MS27595-319
MS27595-321
MS27595-324
MS27595-325
MS27595-326
MS27595-327
MS27595-328
MS27595-329
MS27595-330
MS27595-331
MS27595-332
MS27595-333
MS27595-334
MS27595-335
MS27595-336
MS27595-337
MS27595-338
MS27595-339
MS27595-340
MS27595-341
MS27595-342
MS27595-343
MS27595-344
MS27595-345
MS27595-346
MS27595-347
MS27595-348
MS27595-349
MS27595-350
MS27595-351
MS27595-354
MS27595-357
MS27595-358
MS27595-359
MS27595-360
MS27595-361
MS27595-363
MS27595-364
MS27595-365
MS27595-366
MS27595-367
MS27595-368

MS27595 Solid PTFE Backups, cont'd.

Part No.
MS27595-369
MS27595-370
MS27595-377
MS27595-378
MS27595-379
MS27595-382
MS27595-383
MS27595-425
MS27595-426
MS27595-427
MS27595-428
MS27595-429

Part No.
MS27595-430
MS27595-431
MS27595-432
MS27595-433
MS27595-434
MS27595-435
MS27595-436
MS27595-437
MS27595-438
MS27595-439
MS27595-440
MS27595-441

Part No.
MS27595-442
MS27595-443
MS27595-444
MS27595-445
MS27595-446
MS27595-447
MS27595-448
MS27595-449
MS27595-450
MS27595-451
MS27595-452
MS27595-453

Part No.
MS27595-454
MS27595-455
MS27595-456
MS27595-457
MS27595-458
MS27595-459
MS27595-460
MS27595-462
MS27595-465
MS27595-468
MS27595-469
MS27595-472

MS28774 Split PTFE Backups - Inch



EXAMPLE: MS28774-352	
Prefix	AS568 DASH #
MS28774-	352

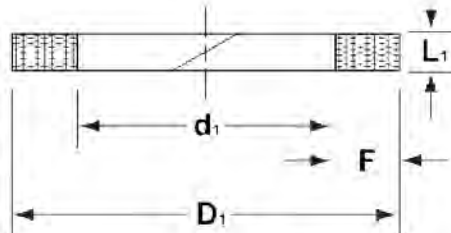

These split PTFE backup rings are machined from virgin PTFE to military specifications and are popular in commercial applications requiring low friction, fluid compatibility or high temperature. These parts do not meet Mil-Spec testing requirements. Prices can be quoted for Mil-Spec applications requiring additional testing and certification.

Part No.
MS28774-004
MS28774-005
MS28774-006
MS28774-007
MS28774-008
MS28774-009
MS28774-010
MS28774-011
MS28774-012
MS28774-013
MS28774-014
MS28774-015
MS28774-016
MS28774-017
MS28774-018
MS28774-019
MS28774-020
MS28774-021
MS28774-022
MS28774-023
MS28774-024
MS28774-025
MS28774-026
MS28774-027
MS28774-028
MS28774-029
MS28774-031
MS28774-036
MS28774-042
MS28774-108
MS28774-109
MS28774-110
MS28774-111
MS28774-112
MS28774-113

Part No.
MS28774-114
MS28774-115
MS28774-116
MS28774-117
MS28774-118
MS28774-119
MS28774-120
MS28774-121
MS28774-122
MS28774-123
MS28774-124
MS28774-125
MS28774-126
MS28774-127
MS28774-128
MS28774-129
MS28774-130
MS28774-131
MS28774-132
MS28774-133
MS28774-134
MS28774-135
MS28774-136
MS28774-137
MS28774-138
MS28774-139
MS28774-140
MS28774-141
MS28774-142
MS28774-143
MS28774-144
MS28774-145
MS28774-146
MS28774-154
MS28774-162

Part No.
MS28774-204
MS28774-206
MS28774-208
MS28774-210
MS28774-211
MS28774-212
MS28774-213
MS28774-214
MS28774-215
MS28774-216
MS28774-217
MS28774-218
MS28774-219
MS28774-220
MS28774-221
MS28774-222
MS28774-223
MS28774-224
MS28774-225
MS28774-226
MS28774-227
MS28774-228
MS28774-229
MS28774-230
MS28774-231
MS28774-232
MS28774-233
MS28774-234
MS28774-235
MS28774-236
MS28774-237
MS28774-238
MS28774-239
MS28774-240
MS28774-241

Part No.
MS28774-242
MS28774-243
MS28774-244
MS28774-245
MS28774-246
MS28774-247
MS28774-271
MS28774-272
MS28774-276
MS28774-324
MS28774-325
MS28774-326
MS28774-327
MS28774-328
MS28774-329
MS28774-330
MS28774-331
MS28774-332
MS28774-333
MS28774-334
MS28774-335
MS28774-336
MS28774-337
MS28774-338
MS28774-339
MS28774-340
MS28774-341
MS28774-342
MS28774-343
MS28774-344
MS28774-345
MS28774-346
MS28774-347
MS28774-348
MS28774-349